

# TL9

## series

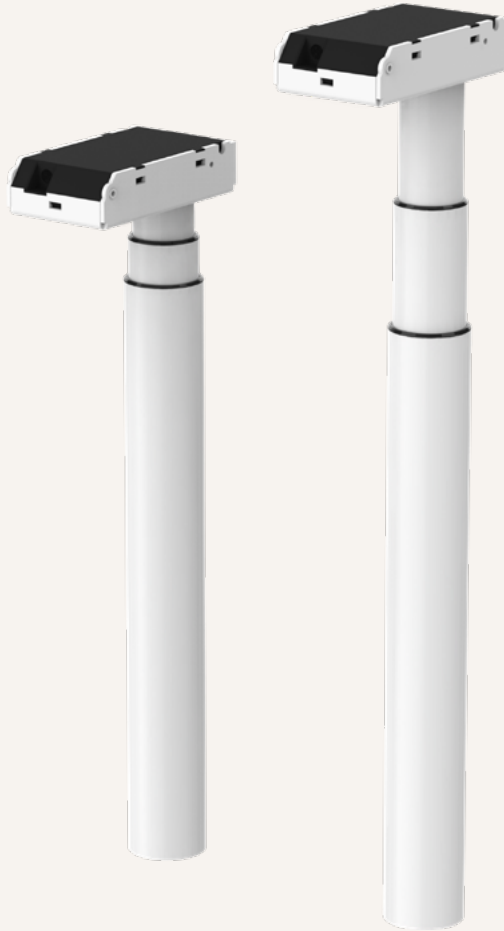

### Product Segments

#### • Ergo Motion

TiMOTION's TL9 series lifting columns are specifically designed for use in ergonomic desks and work tables. Using multiple TL series lifting columns with compatible TC series Control Boxes and TH/TDH series controls, work surfaces can be controlled quietly and smoothly with synchronous movement. All Ergo Motion TC series control boxes have a less than 0.1W standby power option that reduces power consumption. Our wide range of columns offer customers the solutions they require to satisfy their working environment project requirements. The TL9 has a three stage telescopic outer tube that is designed for a narrow-top, wide-bottom round appearance.

#### General Features

Max. load	800N (push)
Max. speed at max. load	33mm/s
Max. speed at no load	58mm/s
Retracted length	Standard (compatible with foot): 590 / 560(M) / 520(S)mm Extended (compatible with shoe): 610 / 580(M) / 540(S)mm
Dimension of outer tube	Ø70mm round
Stages	3-stage
Stroke	650 / 660 (M, S) mm
Output signals	Hall sensors
Voltage	24V DC
With motor house	

The TL9 can only be used in pairs; single column usage is not recommended

**Drawing**

Standard Dimensions  
(mm)

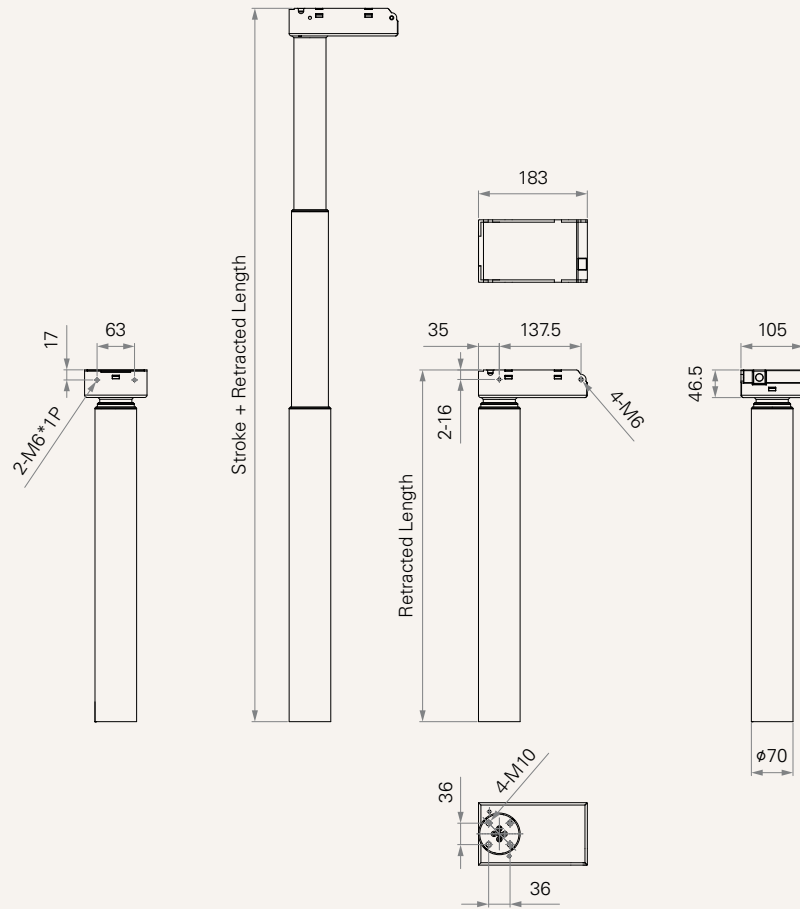

**Load and Speed**

CODE	Load (N)	Self Locking Force (N)	Typical Current (A)		Typical Speed (mm/s)	
	Push		No Load 32V DC	With Load 24V DC	No Load 32V DC	With Load 24V DC

**Motor Speed (5200RPM)**

<b>C</b>	800	800	2.8	6.0	58.0	33.0
----------	-----	-----	-----	-----	------	------

**Note**

- 1 Above self lock performance needs working with Timotion control system.
- 2 Parameters above are from tested average, please refer to approval drawing for final value.

**Performance Data (24V DC Motor)**

Motor Speed (5200RPM)

Speed vs. Load

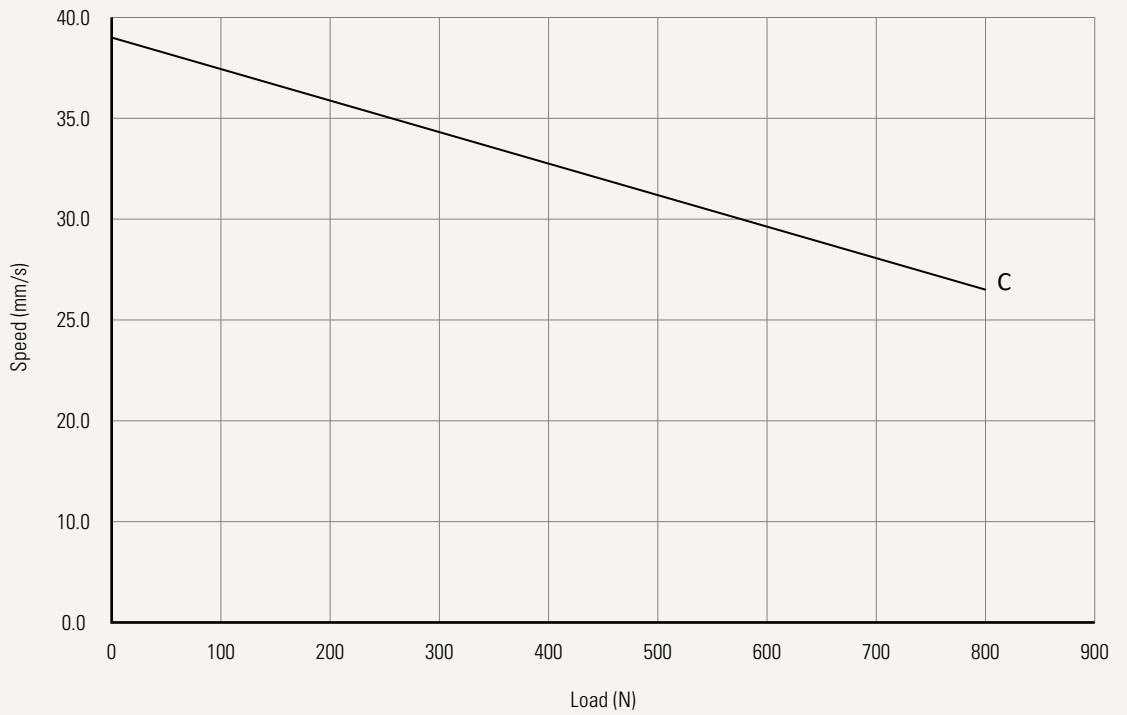

Current vs. Load

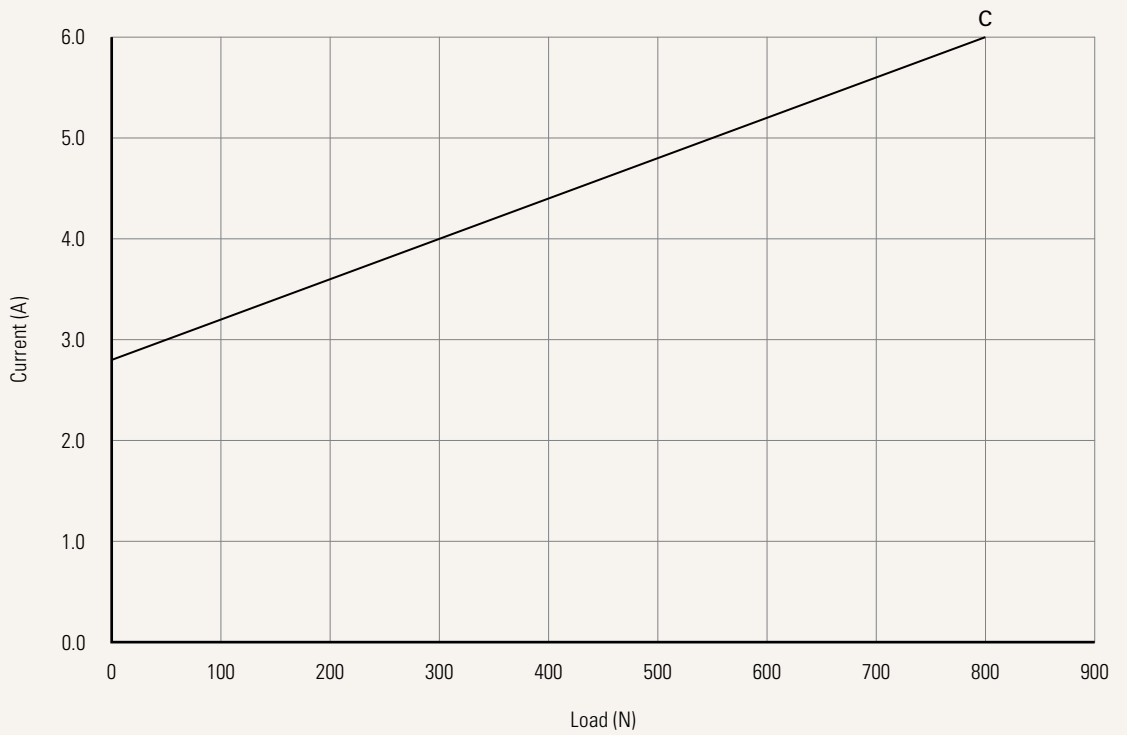

**Note**

1 The performance data in the curve charts shows theoretical value.

<b>Appearance of Tubes</b> <a href="#">See page 5</a>	B = With wiper fixing holes at sides	C = Without wiper fixing holes at sides
<b>Voltage</b>	2 = 24V	
<b>Load and Speed</b>	<a href="#">See page 2</a>	
<b>Stroke &amp; Retracted Length (mm)</b>	<a href="#">See page 5</a>	
<b>Color</b>	1 = Black, RAL 9005, Black wiper 2 = Grey, RAL 9006, Black wiper 3 = White, RAL 9016, Black wiper 4 = Special grey, RAL 9022, Black wiper 6 = Grey, RAL 9006, Grey wiper	7 = White, RAL 9016, White wiper 8 = Special grey, RAL 9022, Grey wiper B = Matte black, RAL 7021, Black wiper C = Graphite grey (RAL7024), Black wiper D = Matte black, RAL 7021, Matte Black wiper
<b>Motor Gearbox Step</b>	0 = With	1 = Without
<b>Output Signals</b>	2 = Hall sensors*2	
<b>Plug</b> <a href="#">See page 5</a>	1 = DIN 6P, 90° plug	E = Molex 8P, plug, standard
<b>Cable Length (mm)</b>	1 = Straight, 500	4 = Straight, 1500
<b>Bracket</b> <a href="#">See page 6</a>	0 = Without 5 = Left, triangle bracket	6 = Right, triangle bracket 7 = Front, triangle bracket 8 = Back, triangle bracket

### Note

<sup>1</sup> The TL is designed especially for push applications, not suitable for pull applications.

## Stroke & Retracted Length (mm)

Foot Assembly	Stroke / Retracted Length		
	Standard	M	S
<b>Standard</b>	650 / 590	660 / 560	660 / 520
<b>With Shoes</b>	650 / 610	660 / 580	660 / 540

## Foot Assembly

Standard



With Shoes



## Appearance of Tubes

B = With wiper fixing holes at sides



C = Without wiper fixing holes at sides



## Connector

1 = DIN 6P, 90° plug

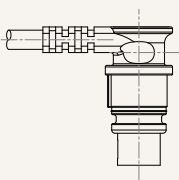

E = MOLEX 8P, plug, standard

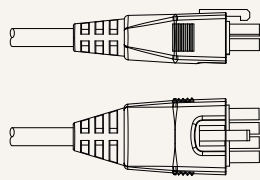

## Bracket

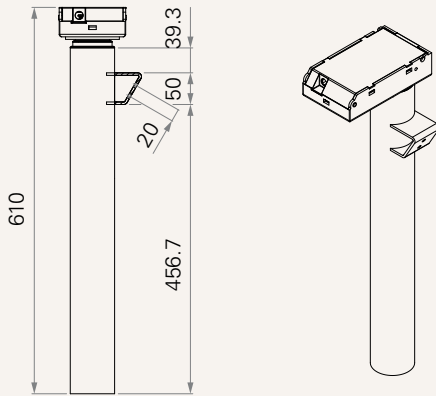

## Terms of Use

The user is responsible for determining the suitability of TiMOTION products for a specific application. TiMOTION products are subject to change without prior notice.